

# DAILY INSPECTIONS. NIGHTLY WASHDOWNS. THE PERFECT LOCATION FOR THE FV SERIES LUMINAIRE.



Appleton's advanced FV™ Series Luminaire offers a host of exclusive safety and performance features that deliver durable, efficient lighting to hazardous and industrial locations. The FV Series' rugged polycarbonate cover and corrosion-proof housing outlast years of punishing environments. Maintenance is a snap with one-handed access to a single actuator, hinged lens and hinged internal reflector. Most importantly, an automatic unit kill switch protects service crews from power-related accidents. The FV Series also boasts reduced operational costs with a stellar 94% light-producing efficiency rating.

Find out more about Appleton's FV Series Luminaire by visiting [www.appletonelec.com](http://www.appletonelec.com) or calling 1.800.621.1506.



EMERSON. CONSIDER IT SOLVED.™

# F3-2

## FV™ Series Non-Metallic Fluorescent For Hazardous and Adverse Locations

### Applications

- For use in hazardous locations defined by the NEC as Class I, Div. 2, Groups A, B, C and D; Class II, Div. 2, Groups F and G; Marine Outdoor Salt Water; UL1598A; Type 4X; and Class I, Zone 2 II C.
- For use in locations where a high degree of corrosion resistance is required.
- For indoor or outdoor use where protection against dirt, water and moisture is necessary.
- Typical applications include oil refineries, petrochemical facilities, pulp and paper mills, food processing plants, warehouses, underground tunnels and general manufacturing facilities.

### Features

- Stainless steel hubs (3/4") provided as standard.
- Ballast options for nearly all U.S. and foreign voltage and frequency combinations are available.
- Low operating costs provide more lumens per watt than incandescent fixtures.
- Impact-resistant polycarbonate lens is hinged to allow easy access to lamp compartment.
- Corrosion-resistant fiberglass-reinforced polyester housing.
- Actuator allows access to lamps and ballast compartment – no tools required.
- Latch assembly and elastomer type gasket provide positive seal from water ingress.
- Safety switch (supplied as standard) disconnects power to lamps and ballast when lens is open.
- Reflector is hinged for easy single-handed entry to ballast compartment.
- Actuator can be removed for tamper-resistant applications.

### Standard Materials Of Fixture

- *Housing:* fiberglass-reinforced polyester.



- *Lens:* polycarbonate.
  - *Gasket:* elastomer.
  - *Hubs:* stainless steel.
  - *Lamp holders:* polycarbonate.
  - *Internal reflector:* highly reflective white polycarbonate.
- ### Standard Materials Of Mounting Accessories
- *Fixed surface mount:* (2) 14-gauge stainless steel.
  - *Adjustable wall mount:* (2) copper-free aluminum.
  - *45° fixed wall mount:* (2) 11-gauge (1/8") stainless steel
  - *Chain ring bolt:* set of 2 zinc plated steel (internal diameter .78").
- ### Options
- *Individually fused ballast.* Add suffix **-F**.
  - *Terminal block.* Add suffix **-T**.
  - *Emergency battery pack.* Add suffix **-EL**.
  - *Emergency light capability* in moments of power interruption. Luminaire automatically switches to emergency mode, keeping one lamp illuminated for a minimum of 90 minutes. When AC power is restored, battery automatically recharges in 24 hours. Initial light output is 600-700 lumens.

### Compliances

- Class I, Div. 2, Groups A,B,C,D
- Class II, Div. 2, Groups F,G
- Type 4X Wet Locations
- UL844
- UL1598A
- Marine Type Electric Fixture Outside Type (Salt Water)\*

\* Does not apply to fixtures with fusing.

Class I, Div. 2, Groups A,B,C,D  
 Class II, Div. 2, Groups F,G  
 Marine Type Electric Fixture  
 Outside Type (Salt Water)  
 Type 4X  
 Wet Locations  
 UL844  
 UL1598A

## FV™ Series Non-Metallic Fluorescent Ordering Information

### Ordering Information:

Order using catalog numbering guide below or select catalog number from tables below.

### CATALOG NUMBERING GUIDE FOR FV SERIES NON-METALLIC FLUORESCENT LUMINAIRES

<b>FV</b>   <b>SERIES:</b> FV - FV Series	<b>P</b>   <b>LAMP TYPE:</b> P - "PL" Fluorescent (F40BX) R - Rapid Start H - High Output	<b>2</b>   <b>NUMBER OF LAMPS:</b> 2 - 2 Lamps 3 - 3 Lamps 4 - 4 Lamps	<b>32</b>   <b>WATTAGE:</b> 32 - 32 W (T8) 40 - 40 W (T12-RS, F40BX) 44 - 44 W (T8-HO) 60 - 60 W (T12-HO)	<b>BU</b>   <b>VOLTAGE*:</b> 120 - 120 V 60 Hz 277 - 277 V 60 Hz 347 - 347 V 60 Hz 1250 - 120 V 50 Hz† 2250 - 220 V 50 Hz† 2260 - 220 V 60 Hz† 2450 - 240 V 50 Hz† 2460 - 240 V 60 Hz† BU - 120-277 V 50/60 Hz•	 <b>BALLAST TYPE:</b> S0 - Solid State Octron (for T-8) SS - Solid State (for T-12) Blank - Solid State (for F40BX and Octron)	<b>F</b>   <b>OPTIONS:</b> F - Fuse T - Terminal Block (6 Point) EL - Emergency Battery Pack**
--	---	---	---	--	---	--

See catalog page F3-4 for start temperatures  
 \* Consult factory for availability of specific voltages.  
 \*\*4' fixture only.  
 † 40W SS HO, 60W HO only.  
 • 32W SS Octron and F40BX only.



Number of Lamps†	Lamp Watts	Lamp Type	Hub Size (Inches)	Overall Fixture Length (Inches)	Volts	Catalog Number
2	40	F40BX	3/4	31	120-277	FVP240BU
4	40	F40BX	3/4	55	120-277	FVP440BU
2	32	T8	3/4	55	120-277	FVR232BU
2	44	T8-HO	3/4	55	120	FVH244-120S0
2	44	T8-HO	3/4	55	277	FVH244-277S0
2	40	T12	3/4	55	120	FVR240-120SS
2	40	T12	3/4	55	277	FVR240-277SS
2	60	T12-HO	3/4	55	120	FVH260-120SS
2	60	T12-HO	3/4	55	277	FVH260-277SS
3	32	T8	3/4	55	120-277	FVR332BU

† Lamps not included.

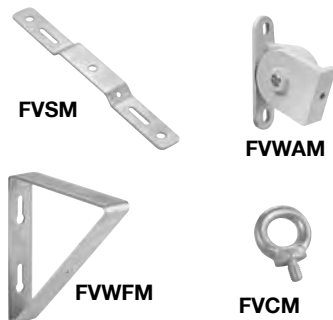

### FV Series Mounting Accessories‡

Catalog Number	Description	Standard Materials
FVSM	Surface Mount (set of 2)	14-gauge stainless steel
FWAM	Adjustable Wall Mount (set of 2)	Copper-free aluminum
FWWM	Fixed 45° Wall Mount (set of 2)	11-gauge (1/8") stainless steel
FVCM	Chain Mount (set of 2)	Zinc plated steel M8 ring bolts (chain not provided)

‡ Mounting accessories ordered separately.

# F3-4

Class I, Div. 2  
Groups A,B,C,D  
Class II, Div. 2, Groups F,G  
Marine Outdoor Saltwater  
Type 4X  
Wet Locations  
UL844, UL1598A

## FV™ Series Non-Metallic Fluorescent Technical Data and Dimensions

### Technical Data: Thermal Performance of FV Series Fixtures:

Fixture	Lamp			Lamp Lumens	Min. Start Temp (°C/°F)	Ambient Temp. (°C)	"T" Numbers
	Quantity	Watt	Type				
FVP240BU	2	40	F40BX	3300	-18/0	55	T4
FVP440BU	4	40	F40BX	3300	-18/0	55	T4
FVR232BU	2	32	T8-RS	2850	-18/0	40	T6
FVH244-120S0	2	44	T8-HO	4050	-18/0	40	T6
FVH244-277S0	2	44	T8-HO	4050	-18/0	40	T6
FVR240-120SS	2	40	T12-RS	3050	10/50	40	T5
FVR240-277SS	2	40	T12-RS	3050	10/50	40	T5
FVH260-120SS	2	60	T12-HO	4050	-28/-20	40	T4A
FVH260-277SS	2	60	T12-HO	4050	-28/-20	40	T4A
FVR332BU	3	32	T8-RS	2850	-18/0	40	T6

Note: For supply connection, use wire rated 75 °C.

### Dimensions in Inches

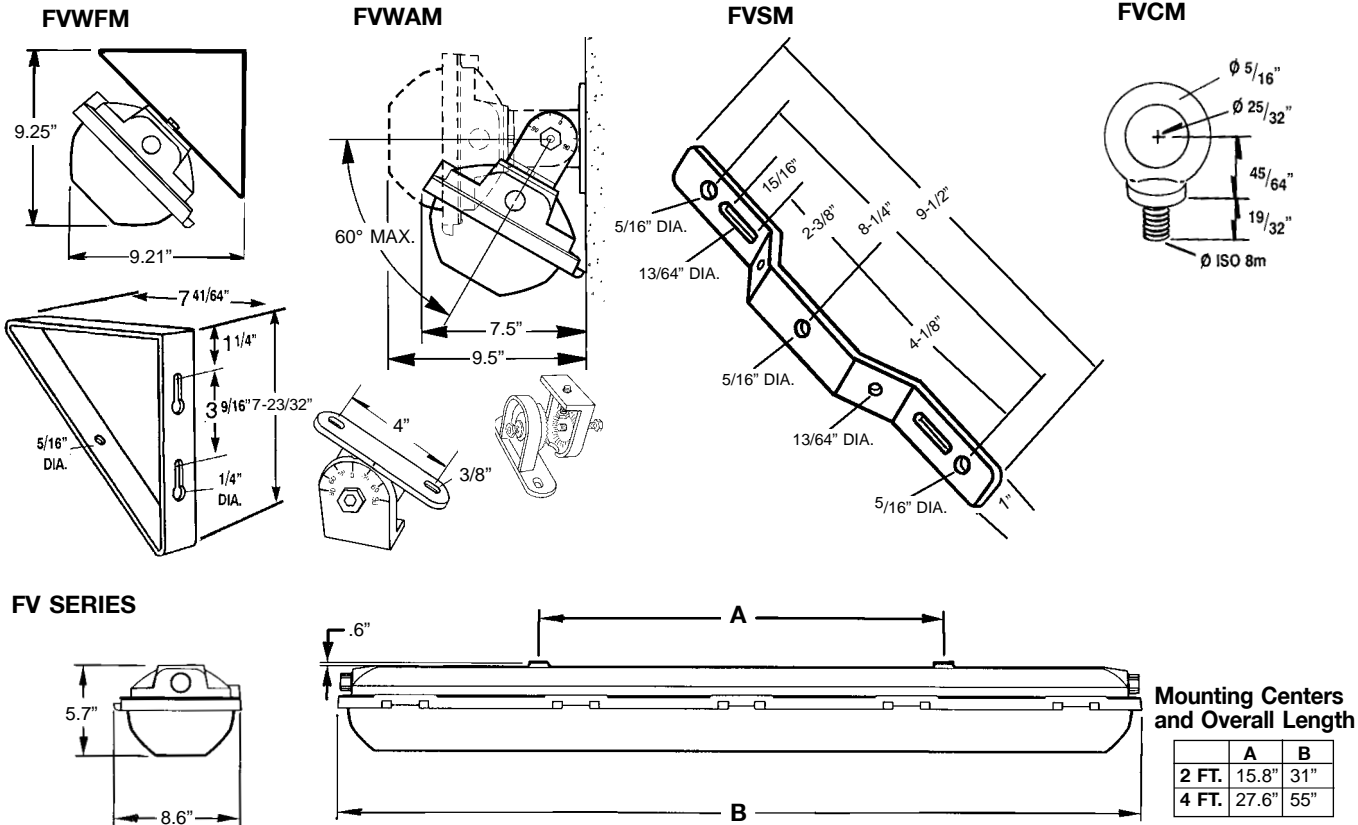

FM Series Non-Metallic Fluorescent Photometric Data

Coefficients of Utilization - Zonal Cavity Method

CIE TYPE - DIRECT

PLANE: 0 DEG. 90 DEG.

SPACING CRITERIA: 1.2 1.5

CANDELA DISTRIBUTION table with columns for 0.0, 45.0, 90.0, and ZONAL LUMENS.

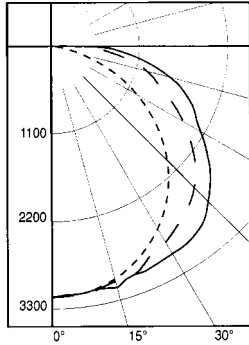

FVP 240, Two 40 W PL Lamps • Total Luminaire Efficiency = 92.7%

% Floors Rfc, % Ceiling Rcc, % Walls Rww, Room Cavity Ratio tables for FVP 240.

CIE TYPE - DIRECT

PLANE: 0 DEG. 90 DEG.

SPACING CRITERIA: 1.2 1.5

CANDELA DISTRIBUTION table for FVP 440.

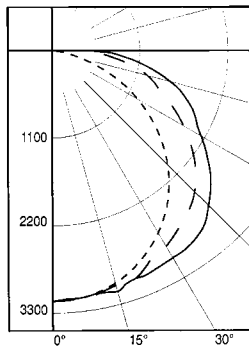

FVP 440, Four 40 W PL Lamps • Total Luminaire Efficiency = 85.8%

% Floors Rfc, % Ceiling Rcc, % Walls Rww, Room Cavity Ratio tables for FVP 440.

CIE TYPE - DIRECT

PLANE: 0 DEG. 90 DEG.

SPACING CRITERIA: 1.2 1.5

CANDELA DISTRIBUTION table for FVR 232.

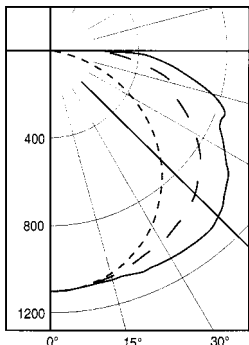

FVR 232, Two T8 32 W Lamps\* • Total Luminaire Efficiency = 77.4%

% Floors Rfc, % Ceiling Rcc, % Walls Rww, Room Cavity Ratio tables for FVR 232.

\* For candlepower of: a 40W T12, multiply by 0.772; a 44W T8, multiply by 1.404; a 60W T12, multiply by 1.421.

CIE TYPE - DIRECT

PLANE: 0 DEG. 90 DEG.

SPACING CRITERIA: 1.2 1.4

CANDELA DISTRIBUTION table for FVR 332.

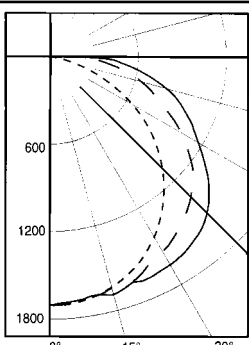

FVR 332, Three T8 32 W Lamps • Total Luminaire Efficiency = 75.7%

% Ceiling Rcc, % Walls Rww, Room Cavity Ratio tables for FVR 332.